

## Specs:

Bedrooms:	3
Bathrooms:	2
Square Footage:	1,864 Sq.Ft.
First Level:	1,525 Sq. Ft.
Second Level:	339 Sq. Ft.
Width:	38' - 10"
Depth:	56' - 2"

## Options Shown:

- 1 Covered Porch
- 2 Screened in Porch
- 3 Sunroom (Adds 144 Sq.Ft.)
- 4 Sunroom 'B' (Adds 217 Sq.Ft.)
- 5 3'-0" Wider Garage w/ Two Doors
- 6 2'-0" Garage Extension
- 7 Bedroom 4 and Bath 3 (Adds. 268 Sq. Ft.)
- 8 Attic Storage
- 9 Window at Dining Area

Watercolors, illustrations, and floor plans are for marketing purposes only and are subject to change at builder's discretion. Square footage is outside veneer and should be independently verified. This is not a legal document.

6/6/2023 9:58:45 AM



# FLOOR PLAN: HATTERAS TRANSITIONAL

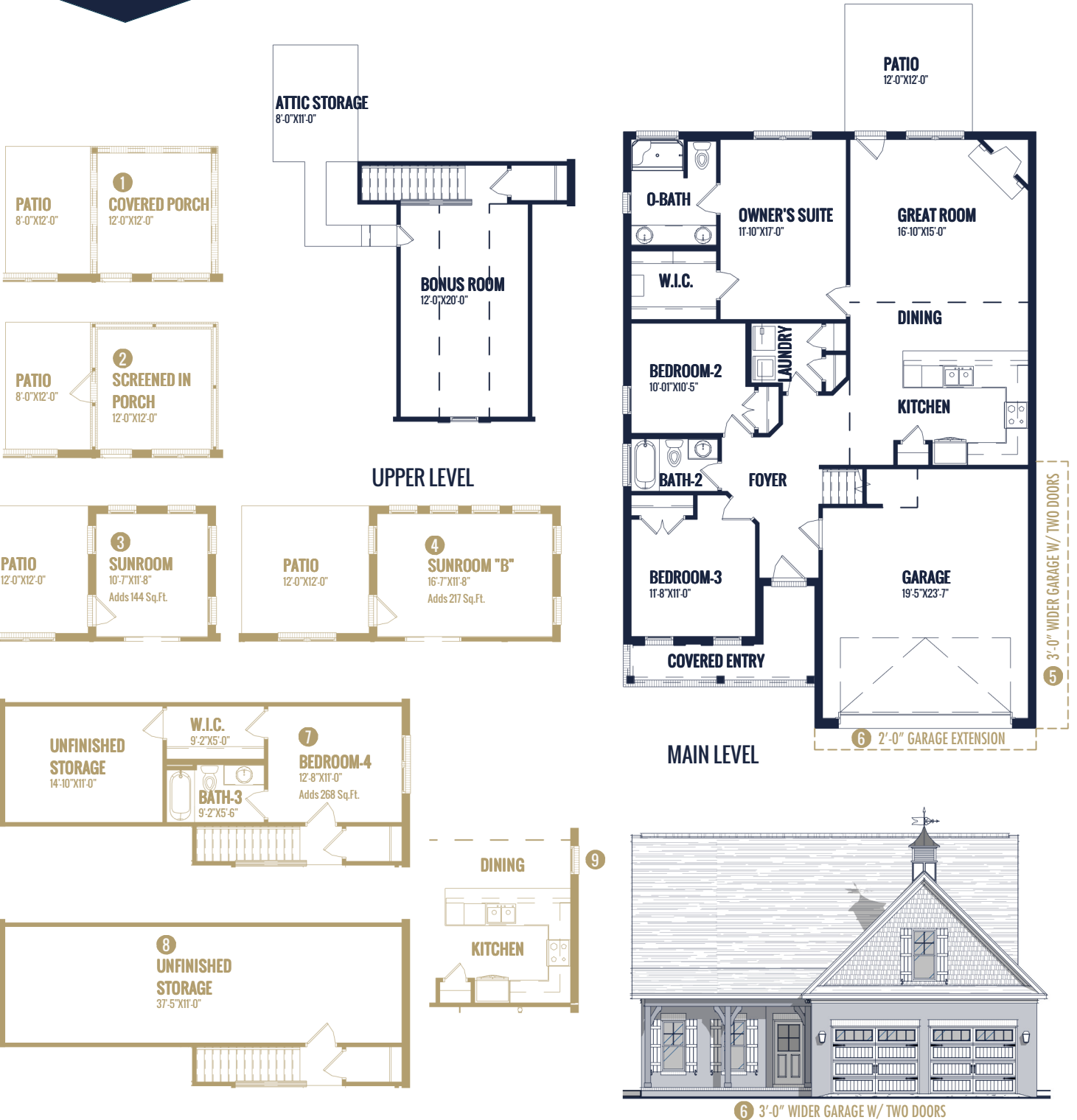

Watercolors, illustrations, and floor plans are for marketing purposes only and are subject to change at builder's discretion. Square footage is outside veneer and should be independently verified. This is not a legal document. 6/6/2023 9:58:49 AM

